

FOR IMMEDIATE RELEASE

December 8, 2021



CONTACT:

Christopher Quan Le
Public Information Officer
The City of Stanton
(714) 890-4264
PIO@StantonCA.gov

CITY ANNOUNCES AWARD OF PROPOSITION 68 GRANT

\$7.69m has been funded by California State Parks under the Statewide Park Development and Community Revitalization Grant Program to revitalize the Norm Ross Complex

Stanton, Calif. (Dec. 8, 2021): Officials announced today that \$7.69 million in state funding has been secured to revitalize the Norm Ross Sports Complex located at 11111 Cedar St. This park space is currently inoperable due to poor field conditions, inefficient lighting, and other outdated equipment. The improvement project will meet a critical need in the Stanton community and will allow residents to utilize the complex for outdoor recreation.

To ensure the project was shaped by community-driven involvement, the Community Services Department conducted park design surveys and various community workshops with several community groups and residents.

The rehabilitation of the Sports Complex will result in a variety of healthy recreational and social opportunities for the City's diverse population, including a new baseball/softball diamond, multi-purpose field, and multi-sport court for basketball volleyball, and pickleball. The proposed park design also includes a flat pedestrian trail, group picnic areas, enhanced community garden and dog park to further improve the versatility of the park space. Drought-tolerant landscaping and environmentally friendly design features will ensure that the project is sustainable during construction and beyond. This project is expected to be completed by March 2025.

"This opportunity to create a thriving park space would not have been possible without the passage of Proposition 68 and the leadership of California State Parks," said Jarad Hildenbrand, Stanton City Manager. "This funding is a transformative investment in our community and we look forward to our continued partnership with the Garden Grove Unified School District to bring much-needed park, programs and services to our Stanton community."

About Stanton

The City of Stanton is located in northwestern Orange County. With a population of more than 39,000 in 3.1 square miles, many residents enjoy the small-town community feeling. The City was incorporated in 1956 and has enjoyed growth and prosperity since that time. The City's motto - Community Pride and Forward Vision identifies Stanton as a place where innovation and pride in the community are an important aspect of life in Stanton.

###

For more information, please contact Christopher Quan Le at (714) 890-4264 or by email at PIO@StantonCA.gov

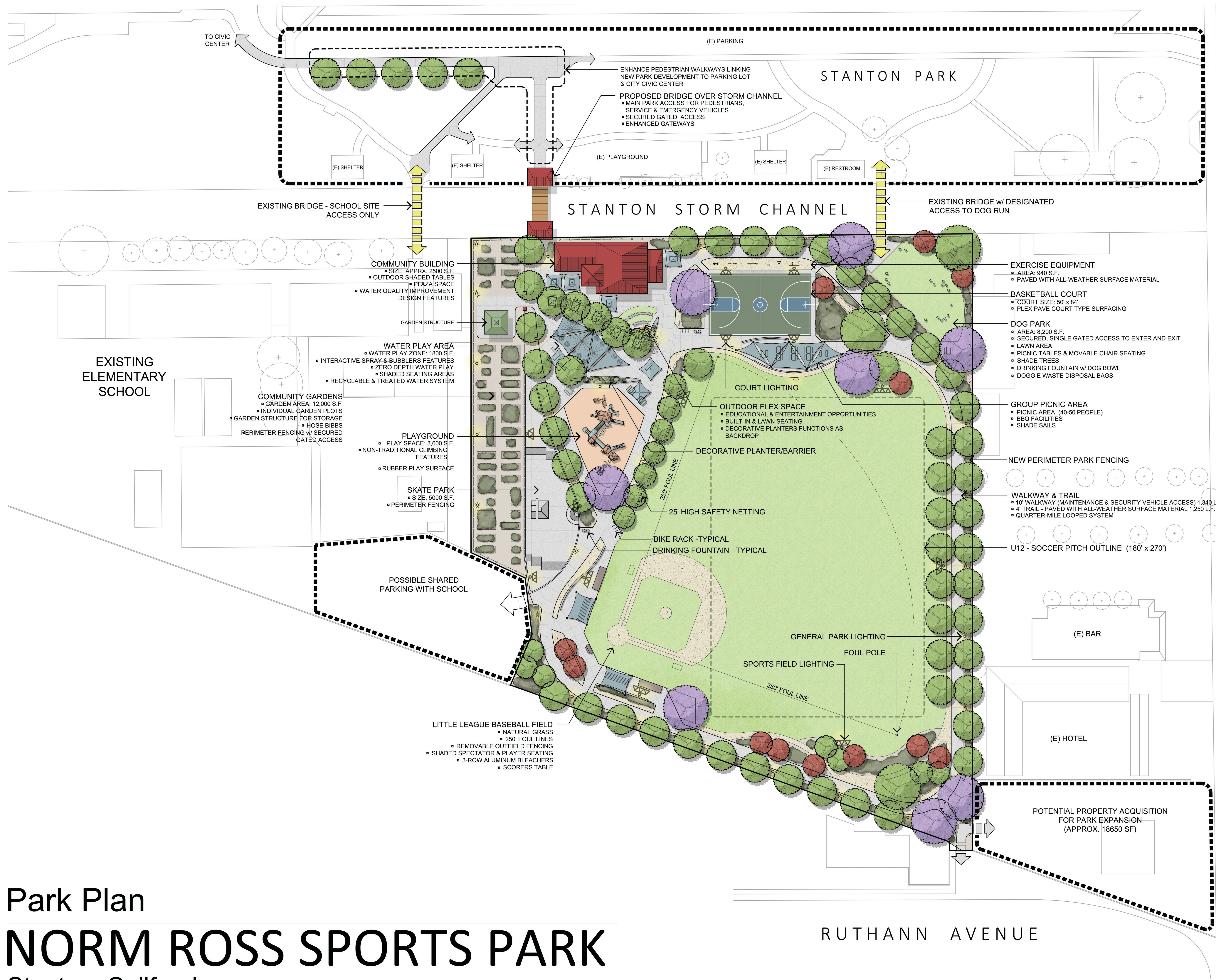

TO CIVIC CENTER

(E) PARKING

STANTON PARK

(E) PLAYGROUND

(E) SHELTER

(E) RESTROOM

EXISTING BRIDGE - SCHOOL SITE ACCESS ONLY

STANTON STORM CHANNEL

EXISTING BRIDGE w/ DESIGNATED ACCESS TO DOG RUN

COMMUNITY BUILDING
 • SIZE: APPRX. 2500 S.F.
 • OUTDOOR SHADED TABLES
 • PLAZA SPACE
 • WATER QUALITY IMPROVEMENT DESIGN FEATURES

WATER PLAY AREA
 • WATER PLAY ZONE: 1800 S.F.
 • INTERACTIVE SPRAY & BUBBLERS FEATURES
 • ZERO DEPTH WATER PLAY
 • SHADED SEATING AREAS
 • RECYCLABLE & TREATED WATER SYSTEM

COMMUNITY GARDENS
 • GARDEN AREA: 12,000 S.F.
 • INDIVIDUAL GARDEN PLOTS
 • GARDEN STRUCTURE FOR STORAGE
 • HOSE BIBBS
 • PERIMETER FENCING w/ SECURED GATED ACCESS

PLAYGROUND
 • PLAY SPACE: 3,600 S.F.
 • NON-TRADITIONAL CLIMBING FEATURES
 • RUBBER PLAY SURFACE

SKATE PARK
 • SIZE: 5000 S.F.
 • PERIMETER FENCING

POSSIBLE SHARED PARKING WITH SCHOOL

LITTLE LEAGUE BASEBALL FIELD
 • NATURAL GRASS
 • 250' FOUL LINES
 • REMOVABLE OUTFIELD FENCING
 • SHADED SPECTATOR & PLAYER SEATING
 • 3-ROW ALUMINUM BLEACHERS
 • SCORERS TABLE

ENHANCE PEDESTRIAN WALKWAYS LINKING NEW PARK DEVELOPMENT TO PARKING LOT & CITY CIVIC CENTER
 PROPOSED BRIDGE OVER STORM CHANNEL
 • MAIN PARK ACCESS FOR PEDESTRIANS, SERVICE & EMERGENCY VEHICLES
 • SECURED GATED ACCESS
 • ENHANCED GATEWAYS

EXERCISE EQUIPMENT
 • AREA: 940 S.F.
 • PAVED WITH ALL-WEATHER SURFACE MATERIAL

BASKETBALL COURT
 • COURT SIZE: 50' x 84'
 • PLEXIPAVE COURT TYPE SURFACING

DOG PARK
 • AREA: 8,200 S.F.
 • SECURED, SINGLE GATED ACCESS TO ENTER AND EXIT
 • LAWN AREA
 • PICNIC TABLES & MOVABLE CHAIR SEATING
 • SHADE TREES
 • DRINKING FOUNTAIN w/ DOG BOWL
 • DOGGIE WASTE DISPOSAL BAGS

GROUP PICNIC AREA
 • PICNIC AREA (40-50 PEOPLE)
 • BBQ FACILITIES
 • SHADE SAILS

NEW PERIMETER PARK FENCING

WALKWAY & TRAIL
 • 10' WALKWAY (MAINTENANCE & SECURITY VEHICLE ACCESS) 1,340 L.F.
 • 4' TRAIL - PAVED WITH ALL-WEATHER SURFACE MATERIAL 1,250 L.F.
 • QUARTER-MILE LOOPED SYSTEM

U12 - SOCCER PITCH OUTLINE (180' x 270')

(E) BAR

(E) HOTEL

POTENTIAL PROPERTY ACQUISITION FOR PARK EXPANSION (APPROX. 18650 SF)

RUTHANN AVENUE

BEACH BLVD

Park Plan

NORM ROSS SPORTS PARK

Stanton, California